

MANUAL

EVOdescale / EVOadsorb / EVOsorb

- Maintenance Manual



EVODROP
WE DO IT BETTER

Manufacturer

Evodrop AG
Birkenstrasse 21
CH-8306 Brütisellen

T +41 44 888 50 05
M info@evodrop.com
W www.evodrop.com



MAINTENANCE OF EVOdescale / EVOadsorb / EVOsorb

Follow this step-by-step guide to properly maintain the EVOdescale / EVOadsorb / EVOsorb. Failure to perform maintenance correctly can result in water damage to your home, for which the manufacturer – Evodrop AG – assumes no liability.

The recommended replacement interval is 12 months in compliance with legal regulations (DIN 1988 / DIN EN 1717). However, an earlier replacement may be necessary if water flow is noticeably reduced or if lime protection significantly decreases. This is not a defect in the filter but an indication of: Increased fine particle accumulation, High lime content in unfiltered water, Above-average water consumption.

Preparation for Maintenance

Prepare the following equipment for maintenance:

- **Maintenance hook & rubber hose (supplied during installation)**
- **Clean towel, microfiber cloth, or similar**
- **A bucket or collection container (minimum 1-liter capacity)**



STEP-BY-STEP GUIDE:



Step 1

Shut off water

1. Turn off the water supply before (a) and after (b) the system by fully closing the respective shutoff valves. If you have a bypass connection for softening systems, simply turn off the water at the bypass valve (c).



Step 2

Drain the filter

2. Connect the hose to the lower valve and direct it into a drain or collection container.
3. Fully open the lower drain valve (counterclockwise).
4. Fully open the upper drain valve (counterclockwise).
5. Keep the hose in the drain or container during the next steps, as more water may be discharged during cartridge replacement.



Step 3

Remove the filter cover

6. Loosen the threaded pin (a) from its holder.
7. Remove the clamp lever lock (b).
8. Separate the housing cover (c) from the body.



Step 4

Dispose of the filter and clean the housing

9. Remove the used filter cartridge from the housing using the maintenance hook. Dispose of it in household waste or recycle it as PP plastic at your local recycling facility.
Important: Ensure the white sealing ring on the filter cartridge is not left in the housing. If it becomes detached during removal, remove it manually.



10. Clean the filter housing if necessary with lukewarm water and a clean cloth. Do not use any cleaning agents.



Step 5

Replace the filter cartridge

11. Carefully insert the new filter cartridge into the housing. Ensure the cartridge is correctly oriented within the housing. **Refer to pages 6 & 7 for more details.**
12. When inserting the new cartridge, some water may discharge from the housing, as the new cartridge is still dry.
13. To ensure proper placement, press the cartridge down slightly and rotate it 180 degrees on its axis.



Step 6

Lubricate a dry or brittle sealing ring

14. Remove the sealing ring from the housing cover.
15. Apply a small amount of silicone grease* evenly to the sealing ring.
16. Reattach the lightly greased sealing ring to the housing cover.



Step 7

Reattach the housing cover

17. Press the housing cover (c) back onto the housing.
18. Align the clamp lever lock (b) flush with the housing cover and body, ensuring the O-ring seal is properly engaged.
19. Reinsert the threaded pin (a) and secure the clamp lever lock manually. Avoid overtightening, as this could damage the seal.

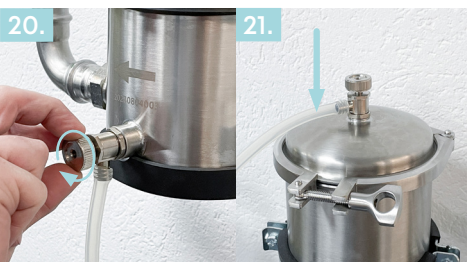

Step 8

Close valves and prepare for venting

20. Fully close the lower drain valve (clockwise).
21. Attach the rubber hose to the upper (still open) valve and direct the hose into a collection container.

Step 9

Turn on water, vent, and check



22. Before commissioning, ensure that the raw water mixing valve on the connection fitting* (bypass), if you have one, is completely closed.
23. Hold the hose securely and slightly open the inlet water at the main valve (a) or the connection fitting* for softening systems (c). Wait until a steady stream of water flows out of the upper drain valve or hose. Once the stream is constant, the housing is vented, and you can fully close the valve (clockwise).



24. Fully open the main valve (a) or the inlet water valve on the connection fitting (c).
25. Check that all connections on the Evodrop system are sealed. If any leaks are detected, immediately turn off the main valve, remove the filter head, and repeat the steps for attaching the filter head starting from Step 6.
26. If all connections are sealed, you can fully open all valves (b) and/or the connection fitting* (c).
27. Now let the water run for approximately ten minutes exclusively through the nearest **cold-water tap** downstream of the system.

* Note on the Connection Fitting / Bypass Module:

Please also follow the manufacturer's instructions for opening and closing the water supply when using connection fittings. At all times, ensure that the mixing valve for blending raw water on the connection fitting (bypass) is **COMPLETELY CLOSED**.

28. If there is consistent flow without pressure or flow loss during flushing, the system is fully maintained and operational.

HOUSING VERSION 1

Housing version with threaded connections (male thread) at the bottom.

EVOdescale



Insert the filter with the flat side facing the housing cover.

The pointed side should face the inlet and outlet.

EVOadsorb



Insert the filter with the flat side facing the housing cover.

The pointed side should face the inlet and outlet.

EVOsorb



Insert the filter with the closed side facing the housing cover.

The open side should face the inlet and outlet.

HOUSING VERSION 2

Housing version with threaded connections (female thread) at the top.

EVOdescale

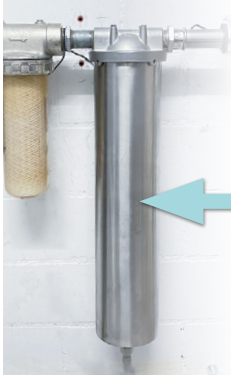

The pointed side should face the inlet and outlet.



Insert the filter with the flat side facing the housing cover.

EVOadsorb

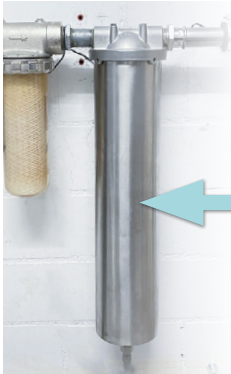

The pointed side should face the inlet and outlet.

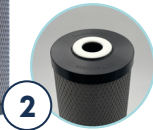

Insert the filter with the flat side facing the housing cover.

EVOsorb

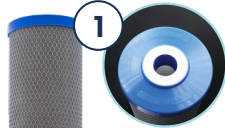
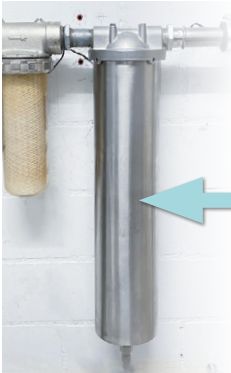

The open side should face the inlet and outlet.



Insert the filter with the closed side facing the housing cover.

If water leaks from the household pipes or any component other than the EVOdescale / EVOadsorb / EVOsorb, contact your plumber as soon as possible.

Warranty for EVOdescale / EVOadsorb / EVOsorb

The product quality is guaranteed under the compensation criteria for consumer damages for 20 years after purchase.

Maintenance Interval and Service

Regular cartridge replacement is essential. Unless otherwise specified, the cartridge must be replaced once a year. However, an earlier replacement may be necessary if: Water flow is noticeably reduced or lime protection significantly decreases. This is not a defect in the filter but an indication of: Increased fine particle accumulation, high lime content in unfiltered water or above-average water consumption.

You can either receive the cartridge by post and perform the maintenance yourself or, for an additional CHF 200 (available only for customers in Switzerland and single-family home (EFH) customers), a service technician can carry out full maintenance of the system.

Disposal of the Filter Cartridge

The filter cartridge of the EVOdescale / EVOadsorb / EVOsorb can be disposed of with household waste. For proper recycling, you can take the cartridge to your local waste collection point to be recycled as PP plastic.

Additional Notes

- Products with damages or malfunctions are subject to Swiss law regarding service, repair, and replacement.
- Repair services after the warranty period may incur additional costs.
- Unauthorized use, disassembly, modification, or improper maintenance of Evodrop water treatment systems is not covered by the warranty.
- Failure to follow this manual voids all warranty claims.
- Evodrop assumes no liability for the use of filter cartridges or water systems from other manufacturers in combination with the EVOdescale / EVOadsorb / EVOsorb.
- If the raw water mixing valve on a connection fitting (bypass) is not fully closed, any related service is not covered under the warranty.